

NOTES

MATERIAL - MILD STEEL
 FINISH - POWDERCOATED TEXTURED MATT BLACK

TO BE SUPPLIED WITH 5MM THK 'STRONG' MAGNETS,
 TO STOP AS MUCH FRICTIONAL MOVEMENT AS POSSIBLE

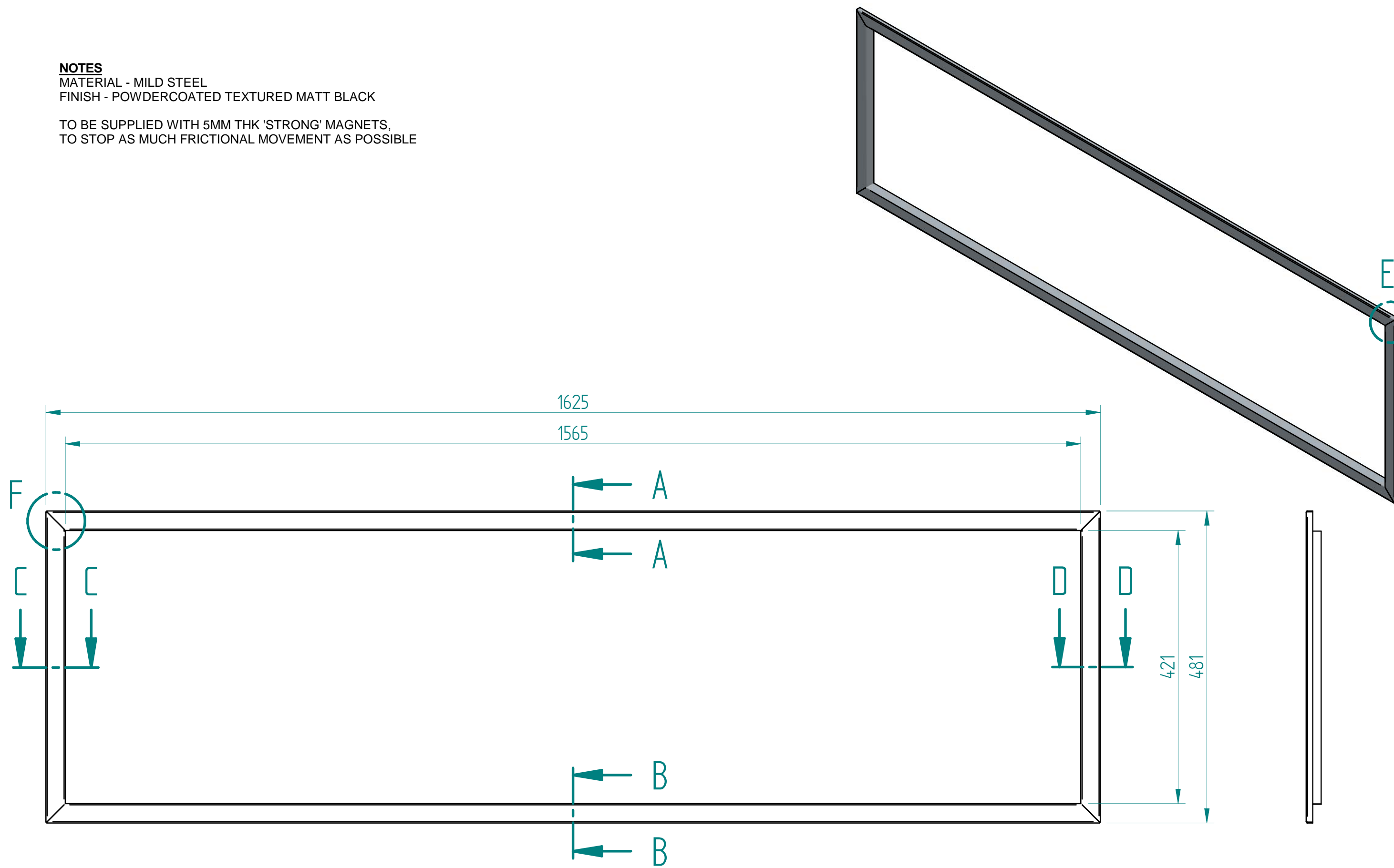

D

C

B

A

FIRST ISSUE 08/01/25 D

LOC. CHANGE & ACTIONED BY DATE ISS.

USED ON NF1600 DRWN: PeterD

SCALE: NTS MATL: SEE NOTES DATE: 08/01/2025 FIN: SEE NOTES CHKD:

PART No: F712305 ISS D
 DESC: TRIM ASSY

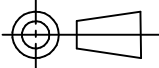

ALL DIMS IN MM
 DO NOT SCALE

ALL COMPONENTS TO BE FREE FROM SILICONE CONTAMINATION AND BURRS.
 TOLERANCES +/- 0.25 UNLESS OTHERWISE STATED. ORIGINAL PAGE SIZE A3

ALL INFORMATION REMAINS THE PROPERTY OF FOCAL POINT FIRES PLC.
 THE COPYING AND DISSEMINATION TO ANY OTHER PARTIES IS NOT PERMITTED WITHOUT EXPRESS PERMISSION OF THE ABOVE.

1

2

3

4