

**NOTES**

MATERIAL - MILD STEEL  
 FINISH - POWDERCOATED TEXTURED MATT BLACK

TO BE SUPPLIED WITH 5MM THK 'STRONG' MAGNETS,  
 TO STOP AS MUCH FRICTIONAL MOVEMENT AS POSSIBLE

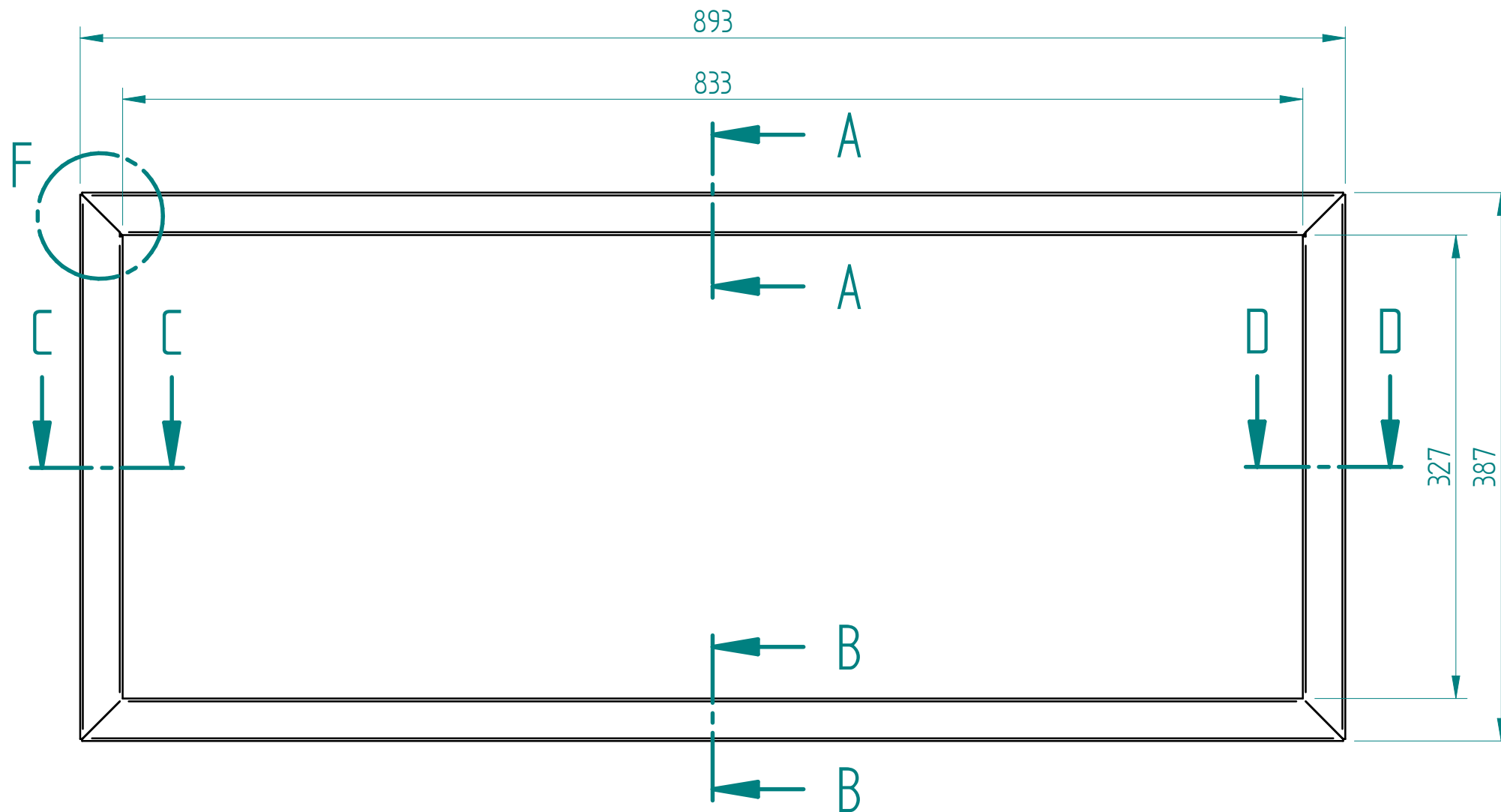

26 WAS 23	03/03/25	E
FIRST ISSUE	07/01/25	D

LOC. CHANGE & ACTIONED BY	DATE	ISS.
USED ON NF870		DRWN: PeterD
SCALE: 1:5	MATL: SEE NOTES	CHKD:
DATE: 09/01/2025	FIN: SEE NOTES	



PART No: F712307	ISS
DESC: TRIM ASSY	E

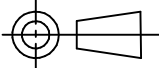

ALL DIMS IN MM  
 DO NOT SCALE

ALL COMPONENTS TO BE FREE FROM SILICONE CONTAMINATION AND BURRS.  
 TOLERANCES +/- 0.25 UNLESS OTHERWISE STATED. ORIGINAL PAGE SIZE A3

ALL INFORMATION REMAINS THE PROPERTY OF FOCAL POINT FIRES PLC.  
 THE COPYING AND DISSEMINATION TO ANY OTHER PARTIES IS NOT PERMITTED WITHOUT EXPRESS PERMISSION OF THE ABOVE.

1

2

3

4